

## SHADOW – Comet 100 RS



### Main Characteristics

<b>Type</b>	Performance sloop	<b>Hull material</b>	Carbon Composite
<b>Shipyard</b>	Comar Yachts	<b>Superstructure</b>	Carbon
<b>Naval architect</b>	A. Vallicelli & Co	<b>Length O. A.</b>	31m / 101'7"
<b>Interior designer</b>	Andrea Valicelli	<b>Beam</b>	6.71m / 22'
<b>Year</b>	2011	<b>Draft</b>	Min 2.7m / 8'85"
<b>Registry</b>	British Virgin Islands		Max 5m / 16'4" (lifiting keel)
<b>Lying</b>	Genoa, Italy	<b>Displacement</b>	65 t.
<b>Price</b>	1'200'000 €	<b>Engine</b>	John Deere 6081 AFM 375hp
<b>VAT Status</b>	EU-VAT paid	<b>Accommodation</b>	8 guests in 4 cabins 4 crew in 2 cabins

## INTRODUCTION

---

The Comet 100RS, SHADOW, from the reputable Italian yard Comar, is a luxurious, high-performance sailing superyacht. This 100' yacht is designed with a sleek silhouette and a sporty yet comfortable cruiser aesthetic.

Its sleek, low coaming, and elongated window panelling, furnish an undeniably streamlined silhouette, a tribute to the expertise of Studio Vallicelli. It's crafted for dual purpose, merging high performance and livable luxury.

The hull is made of a weight-saving blend of carbon fibers and Corecell sandwich laminate for superior sailing performance. It features a lifting keel that can extend from 2.70 to 4.90 meters for flexibility and two rudder blades for swift response to commands.

SHADOW is designed for comfort and enjoyment, with a spacious deck and custom interiors that include six cabins for guests and crew. The owner's stateroom, situated in the bow area, is equipped with all the amenities for an excellent cruising experience.

Powered by robust John Deere engines, Shadow achieves a maximum speed of 12 knots and a cruising speed of 10 knots. With a length of 31 m and a net tonnage of 65 tons, SHADOW truly stands out as a testament to Comar's commitment to creating bigger yachts without compromising on their proven craftsmanship.

Crafted to satisfy the most discerning owner, SHADOW is a perfect balance of luxury, performance, and innovative design.

Incredibly well-priced for a carbon-fiber superyacht, SHADOW is fantastic opportunity!

### KEY FEATURES:

- **Renowned Vallicelli Design and great quality of construction**
- **Performance Yacht**
- **Hull, mast & boom carbon fibre**
- **Ballasted Lifting Keel**
- **Large deck space**
- **Luxurious and roomy interior design with 3 to 4 guest cabins**
- **Unique Stratis Sail Art that adds to the yacht's overall distinctiveness and appeal.**

## CONSTRUCTION &amp; RIGGING

<b>Hull</b>	Carbon
<b>Hull paint:</b>	Grey
<b>Superstructure</b>	Carbon
<b>Deck:</b>	Teak
<b>Keel:</b>	Cariboni Hydraulic lifting keel (draft 2.7m up / 5m down), keel bolts serviced 12/23
<b>Rudder:</b>	Twin carbon fiber rudders
<b>Mast:</b>	Carbon Hall Spars Last service in winter 2019/2020 - 5-year service with ultrasonic scanning and dye test
<b>Boom:</b>	large carbon fibre boom with lazy bag and lazy jacks for easy folding
<b>Standing Rigging:</b>	Rod rigging Last serviced: winter 2019/2020
<b>Backstay:</b>	Kevlar
<b>Running backstay:</b>	Kevlar/Spectra
<b>Furlers:</b>	Genoa: Cariboni hydraulic furling system
<b>Staysail:</b>	Kevlar stay hydraulically tightend and staysail hanked on
<b>Hydraulic System:</b>	Cariboni
<b>Deck Equipment:</b>	Harken
<b>Running Rigging:</b>	Marlow ropes Main & Spinnaker halyard new in 12/2021, Main & Genoa sheet new in 12/2020, Spinnaker halyard block new Harken Snatchblock in 12/2021

## SAILS &amp; WINCHES

<b>Total sail area:</b>	463m2
<b>Mainsail</b>	273 m2 (2015) (Stratis By Doyle)
<b>Foresails</b>	190m2 (2015) (Stratis By Doyle)
<b>Gennaker</b>	710m2 (2011) (One Sails)
<b>Additional sails:</b>	1x Stay Sail, 1x Storm Jib, 1x Tri Sail (OneSails)
<b>Winches</b>	2x Harken 1120 3 Speed hydraulic winch for genoa 1x Harken 1120 3 Speed hydraulic winch for mainsail sheet 2x Harken 3 Speed hydraulic winch for running Backstay 2x Harken 3 Speed hydraulic winch for halyards/reefpoint/downhaul 1x Harken 2 Speed hydraulic winch for mainsail traveller

## MACHINERY/PROPULSION

<b>Engine Make/Model:</b>	John Deere 6081 AFM75, 6 cylinders, 8100 cc-375 HP Engine Hours: @ 4'280 hrs (06/2023) Regularly serviced every winter 12/2022 renewal of belts, filters, oil, impeller heat exchanger cleaned and seals renewed, turbo cleaned and checked, anodes changed, cooling liquid changed. Injectors, valve clearance on a 2-yearly bases Engine control system: Aventix Marex ECS, new in 6/2023 including new cabling, ECU system and gear selector
<b>Gearbox</b>	Twin Disc: Model: MG5061SC
<b>Drive:</b>	Shaft drive to Feathering Propellor, seals renewed, shaft alignment checked in 2019
<b>Propeller:</b>	Max prop 3 blades, in 12/2023 propeller blades changed

## AUXILIARY EQUIPMENT

<b>Bow Thruster:</b>	Maxpower Retractable 30kW, regularly serviced
<b>Steering System:</b>	Dual quadrant
<b>Fuel Separator &amp; Filtration:</b>	Twin Racor separators
<b>Sewage System:</b>	Macerator heads, 3 area system
<b>Lube Oil Capacity:</b>	22 lt main engine
<b>Watermaker:</b>	2x Shenker 100 lt/hr annually serviced (last recommissioned 05/2023)
<b>Ventilation System:</b>	Gianeschi
<b>Air conditioning:</b>	Condaria Double Chiller + Fancoils in all cabins
<b>Hydraulic System:</b>	Cariboni Italy

## TANKAGE

<b>Fuel tank:</b>	5 x Tanks, Total 3'045 lt.
<b>Fresh water tank:</b>	3 x Tanks, Total 2'025 lt.
<b>Grey water tank:</b>	3 x Tanks, Total 555 lt.
<b>Black water tank:</b>	3 x Tanks, Total 544 lt.

## PERFORMANCE

<b>Max. speed:</b>	under power: 12 knots
	under sail: 17 knots
<b>Cruising speed:</b>	under power: 10 knots
	under sail: 12 Knots

## ELECTRIC SYSTEM

<b>Generators:</b>	
<b>Main generator:</b>	Kohler 28 Kw, with dry exhaust system @ 7'551 hrs (06/2023)
<b>Aux. generator:</b>	Kohler 9 Kw, with dry exhaust system @ 2'352 hrs (06/2023)
<b>PTO on generator:</b>	ATOS, replaced in 2020
<b>Batteries:</b>	
<b>Main Engine Starting:</b>	24V, VARTA new in 2022
<b>Generator Starting:</b>	12V, VARTA new in 2022
<b>Battery banks:</b>	Service Bank 1: ZENITH 24V AGM (4 x 6V), new in 11/2024 Service Bank 2: ZENITH 24V AGM (4 x 6V), new in 2022
<b>Waterboilers:</b>	1 x Quick, new in 11/24, 1x Isotemp 65litre new 2021
<b>Emergency:</b>	24v
<b>Transformer:</b>	Two Transformers installed in aft garage
<b>Voltages:</b>	220V, 24V and 12V
<b>Inverter (V/W):</b>	MASTERVOLT 220V/3000W, new in 2019
<b>Battery charger:</b>	MASTERVOLT 3 X 100A, 1 X for Generator Battery 1 X for Main engine Batteries
<b>Shore Power:</b>	2x 63 A @ 230V
<b>Lighting:</b>	24V, LED & Halogen



## NAVIGATION EQUIPMENT

---

### Navigation/Wind/Speed Log/

<b>Chart Plotter:</b>	B&G H 5000 Range including 3 ZEUS-2 Screens, all new in 2014
<b>Radars:</b>	B&G
<b>Gyrocompass:</b>	B&G
<b>Autopilot:</b>	B&G control, hydraulic Gianceschi pump & ram
<b>Depth Sounder:</b>	B&G
<b>GPS:</b>	B&G
<b>Plotter:</b>	B&G
<b>Navtex:</b>	FURUNO NX-300
<b>AIS:</b>	RAYMARINE class B, AIS 650
<b>Barograph:</b>	Yes
<b>Close-hauled and running:</b>	B & G, at both helm stations
<b>Rudder indicator:</b>	B & G
<b>Searchlight:</b>	2x plug in
<b>Horn:</b>	MARCO Air horn

## COMMUNICATION

---

<b>SAT Com:</b>	FURUNO, Inmar sat C, Mod: Falcom 18
<b>VHF:</b>	B & G Nav station and helm
<b>WI-FI:</b>	DIGITAL YACHT 4G and WiFi, new in 2018

## ENTERTAINMENT

---

<b>Television:</b>	1 x Samsung in Salon 49", 1 x TV LG 20" in aft guest cabin, 1 x TV in crew cabin, 1 x Blue-ray player, SONY
<b>Audio Equipment:</b>	Bose surround sound (main saloon) 2 x car stereo units, 1 x CLARION in crew quarters, 1 X LG in owner's cabin

## ACCOMMODATIONS

---

<b>Owner cabin:</b>	Forward, full width, with double bed and en-suite bathroom Extra sound insulation between owner cabin and rest of the boat
<b>Guest cabins:</b>	1x forward from saloon, portside with double bed and en-suite bathroom 1x forward from saloon, Stb.side with bunk beds and en-suite bathroom 1x aft from saloon, portside, with double bed and en-suite bathroom (this cabin can be used as captain cabin)
<b>Crew cabins</b>	2x aft cabins with bunk beds Bathroom: 1
<b>Saloon:</b>	1
<b>Day head:</b>	1
<b>Galley:</b>	1
<b>Crew mess:</b>	1
	Separate entrance for crew area

**Others:**

**Interior:** Teak

**Lights:** LED internal lights and halogen lamps only for reading lights. Dimmer on all lights.

**Curtains:** Oceanair integral recessed blinding curtains in every cabin except crew cabin

**APPLIANCES**

---

**Main Galley Equipment**

**Cooking Equipment:** GN ESPACE 5-burner hob, oven and grill,  
Dual induction hob  
Microwave oven

**Refrigeration/Freezer:** FRIGOMAR double door fridge and single door Freezer

**Dishwasher:** 1 x SMEG ST 4105

**Laundry Equipment:** 1x AEG 6000 series washing machine

**Additional Galley Equipment**

**Refrigeration/Freezer:** 1x custom cockpit fridge integrated under table (outside seating area)  
1x FRIGOMAR wine fridge in main saloon

**DECK EQUIPMENT**

---

**Anchor Windlass:** LOFRANS

**Anchors:** 1 x 100kg Stainless Delta (main),  
1x Danforth

**Anchor Chain:** 180 meters 12mm

**Sea Anchor:** 1 x droughe sea anchor

**Windlass:** Hydraulic

**Capstan:** SANGUINETTI, retractable

**Deck wash system:** Forward and aft with fresh water

**Boat Crane and Davits:** Lifting Spar in boom

**Tender garage:** Yes

**Gangway:** EXIT technology carbon Passarella

**Swimming Platform:** Hydraulic lowering, controlled on helm

**Deck shower:** on aft platform (hot & cold)

**Bathing ladder:** 2x

**Side guardwire gates** 2x with 1 long stair with 4 steps, 1 short stair with two steps for along side boarding

**Wheels:** 2x Titanium

**Bimini and Sprayhood:** in guest cockpit and crew cockpit, renewed with Sunbrella cloth in 2023

**Cushions:** in guest cockpit (seats and central sun area)

**Tables:** 2 cockpit tables

**Fenders:** 11 x Hypalon Fenders, 8 x tube Fenders and 3 x ball Fenders,

**TENDER**

---

**Tender:** Williams Sportjet 395, new in 2018  
with in-built 90HP Rotax engine (40 hours in 07/2023)

**SAFETY**

---

**Security Equipment**

**Cameras:** Raymarine Engine room and Mast head cameras, integrated into B & G system

**Safe:** 2 safe-boxes, one in owner's cabin and one in captain's cabin

### **Alarms**

**Smoke Alarm:** All cabins, engine room and Galley  
**Bilge alarm** Separated into Areas

### **Fire Fighting Equipment**

**Fire Control System:** All equipment serviced every year  
 High pressure CO2 (Engine room),  
 Manual closing for ventilation to engine compartment in case of fire  
 1 x 24 V Fire pump with hose in aft garage and chain locker

**Fire Extinguishers:** 2x HFC227 2kg  
 1x HFC227 3kg  
 9x Dry Powder 1kg  
 1x Dry Powder 3kg  
 2x Foam 9kg

### **Safety Equipment**

**Life Rafts:** AREMAR 2 x 12 Passenger  
 2 x with throw lines,  
 2 x Life Rings with MOB smoke floats  
 1 x JON BUOY RECOVERY MODULE MARK IV, new in 2022  
 2 x JON BUOY Inflatable Rescue Sling JON-3070, new in 2022  
 1 x KIM sail (man overboard recovery system)  
 1 x standard Helicopter lifting strop  
 1 x DAN BUOY-recovery module for 1 person

**EPIRB:** 1 x SAILOR SE 406-II 100-83926

**Flares:** Full set

**SART:** 1 x SAILOR, Mod: SART II (Search & Rescue Transponder for Radar stations)

**Medical Equipment:** Comprehensive medical kit + first aid kit  
 1 x MEDOX Resuscitator, new in 2018  
 1 x CU MEDICAL SYSTEMS - IPAD Defibrillator

**LSA's:** 1x Jonbouy  
 1x Danbouy  
 1x Jonbouy inflatable rescue sling (another 1 to be purchased), New in 2018  
 3x Spinlock life Jackets  
 8x Wetline life Jackets

### **RECENT WORKS**

All but 2 Skylights & Locker hatches were replaced with Solimar including frames, rams, handles etc.

#### **12/2023:**

- Yacht placed ashore for new antifouling, service of keel, bow thruster and rudder
- Service of main engine and generators
- Service of air conditioning pump and bilge pump
- Service of winches and replacement of head sail ram, washing of all sails
- New bow thruster plate
- New Zenith AGM 6V – 410Ah deep cycle batteries
- Service Autopilot
- Service of 12 life jackets, JonBuoy and DanBuoy,
- Epirb annual service, Oxygen kit
- Check of all fire extinguishers, Aux generator extinguisher replaced
- Engine room: Hydrostatic pressure test & refill Co2 for E.R. fixed system



## SHADOW





## SHADOW



Guest cockpit



Crew cockpit with separate entrance to aft crew area





Saloon



Saloon





Owner cabin



Owner cabin





Owner bathroom



Double guest cabin (portside)





Guest cabin (Stb side)



Guest / captain cabin





Galley



Crew mess



## SHADOW

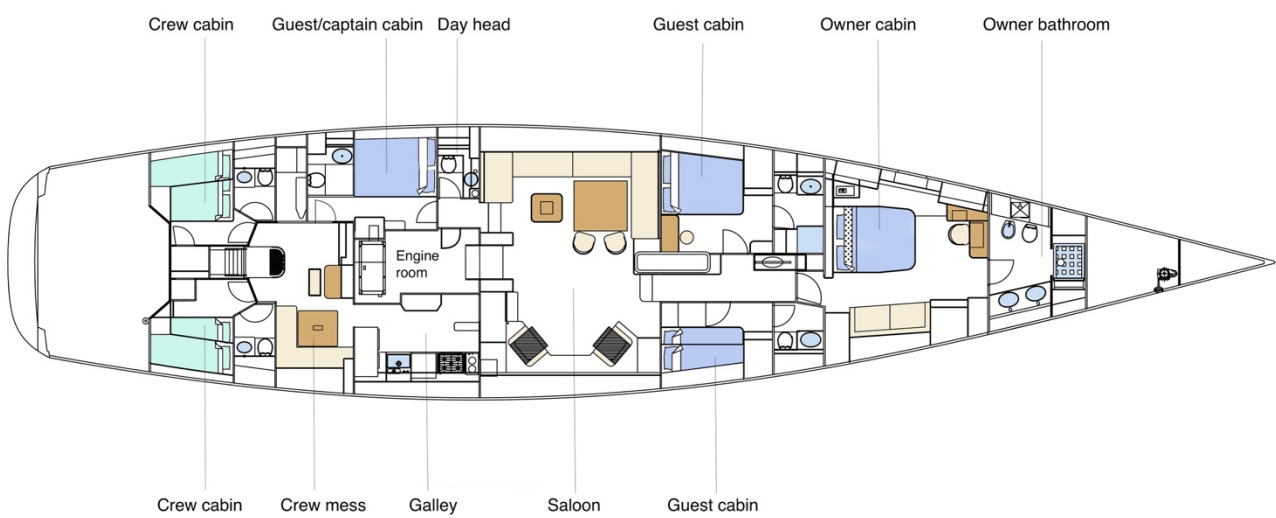
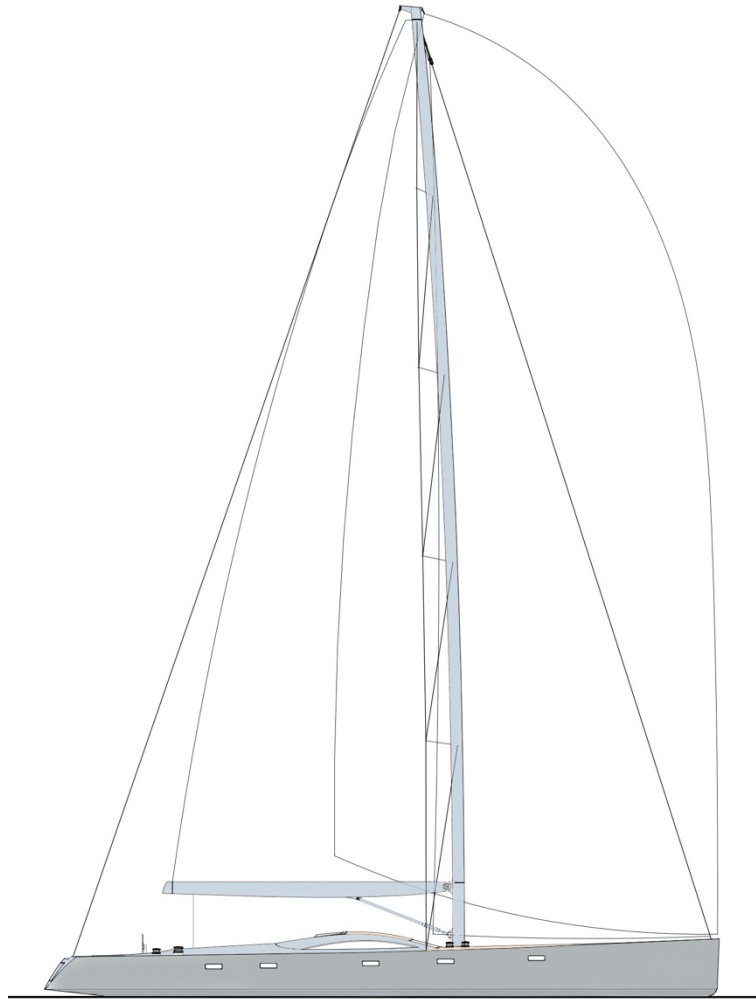

## SHADOW

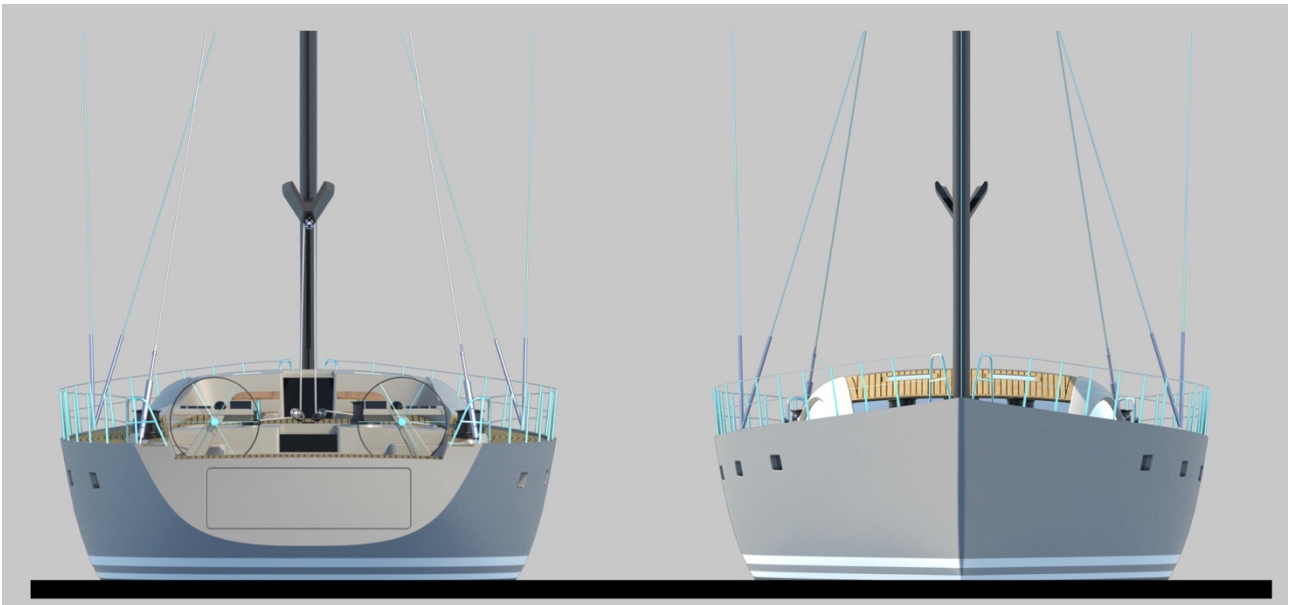

Haas International offers the details of this vessel in good faith but cannot guarantee or warrant the accuracy of this information nor warrant the condition of the vessel. A buyer should instruct his agents, or his surveyors, to investigate such details as the buyer desires validated. This vessel is offered subject to prior sale, price change, or withdrawal without notice.