

Jongert SSS GLORIA



Main Characteristics

| | | | |
|-------------------|--|----------------------|--|
| Name | GLORIA | Hull material | Steel |
| Type | Staysail Schooner | Length O.A. | 38,40m (126') |
| Shipyard | Jongert, NL (hull) Lowland, NL (interior) | Length W.L. | 27,13m (88'58") |
| Architect | Peter Beelsnijder | Length O.D. | 35,00m (114'10") |
| Year | 1986 | Beam | 6,88m (22'7") |
| Registry | UK | Draft | 4,20m (13'9") |
| Lying | Antibes, France | Displacement | 166 tons |
| Price | 2'600'000€ | Sail area | 717m2 |
| VAT Status | Paid (USA + EU) | Engine | 1x Caterpillar 425 HP |
| | | Accommodation | 8 guests in 4 cabins 6 crew in 3 cabins |

INTRODUCTION

A Magnificent Dutch Yachting Masterpiece, a Rare and Outstanding Opportunity

GLORIA is a breathtaking 38.4-meter staysail schooner, with a hull built by Jongert and an interior finished by Lowland in Holland. Designed by Pieter Beeldsnijder as a tribute to the legendary 1936 schooner PANDA by Alfred Mylne, GLORIA is a stunning combination of classical elegance, exceptional craftsmanship, and powerful sailing performance.

Constructed in 1986, GLORIA's steel hull and mahogany-clad aluminum superstructure reflect a level of detail and solidity rarely seen in modern yacht building. Her soaring aluminum masts, traditional deck layout, and gleaming brightwork convey the unmistakable aura of a bygone golden age—yet she is bristling with state-of-the-art sailing technology. In-mast and roller furling systems on all working sails, along with power self-tailing winches, make it possible to sail this magnificent vessel with a small, experienced crew—effortlessly and in any wind.

Inside, GLORIA offers an atmosphere of timeless sophistication. The interior, completed by the Dutch masters at Lowland, features finely crafted mahogany joinery, intricate moldings, leaded glass doors, and luxurious cabinetry. A formal dining area, plush saloon seating, and even a fireplace create an ambiance that is both warm and regal. Skylights bathe the interior in natural light, and every detail speaks to her classic heritage and enduring style. GLORIA accommodates up to eight guests in four generous ensuite staterooms, each finished with the same dedication to quality and comfort. The crew quarters are equally well-appointed, providing room for up to five or six crew, depending on the configuration. Whether for family cruising or refined entertaining, she offers the ideal platform for elegant life at sea.

This is a yacht with not only pedigree, but proven performance. GLORIA has a racing heritage that includes a second-place finish at the Newport Bucket and a class victory at the 2014 Antigua Superyacht Challenge. Her reputation on the water is matched by her care on land: a comprehensive refit at Pendennis Shipyard in 2012 saw her rigging overhauled, teak decks renewed, systems upgraded, and finishes meticulously restored. In recent years, her current owner has overseen a 20-year process of continual improvement, culminating in a fully modernized yacht that remains faithful to her original vision.

GLORIA offers discerning buyers the rare blend of classic elegance, meticulous engineering, thrilling sailing performance, and modern comfort. She stands out in any harbor and delivers a true superyacht sailing experience—well preserved, performance-ready, and beautifully crafted.

Currently located in Antibes, France, GLORIA is in exceptional condition and available for private viewings by appointment. She is not just a yacht—she is an experience, a statement, and a legacy.

KEY FEATURES:

- ◇ **Iconic Heritage:** Modern reinterpretation of Alfred Mylne's legendary "Panda", designed by Pieter Beeldsnijder.
- ◇ **Stunning Craftsmanship:** High-quality mahogany interior, leaded glass, ornate details—an aesthetic masterpiece.
- ◇ **Efficient Sailing:** Advanced staysail schooner rig with furling and hydraulic winches—delivers top-tier performance with minimal crew.
- ◇ **Proven Seakeeping:** Steel hull with proven transatlantic and racing records; reliable crossing ability.
- ◇ **Comprehensive Refit:** Recent upgrades across rig, deck, engineering, and systems maintain peak condition.
- ◇ **Guest Comfort & Amenities:** Luxurious accommodations, AC, entertainment systems and a full suite of water toys.
- ◇ **Charter Potential:** Ready for revenue generation or private cruising—well-known in charter markets with established history.

Message from the Owner:

"Sailing along at 11 to 13 knots on Gloria, effortlessly cruising from place to place, is an experience that is hard to describe. She is a strong, heavy steel yacht of over 160 tons, of traditional design with no gimmicks, but the easily managed sail area drives this massive yacht wonderfully, throwing the sea to one side – it never fails to uplift and excite me.

Gloria was built in 1986. I have tried not to 'modernise' her too much, and also to maintain the elegant patina that she has acquired in her long travels. But where it is important I have poured investment into this beautiful yacht – the duty of guardianship is one of my passions. That sounds pretentious or pompous, but after a few hours aboard Gloria you will understand what I mean. A good classic yacht is like a museum in some ways, but one that can leap across the ocean like a gazelle. The pride of ownership is like nothing else. A responsibility and a duty, but also a joy that can't be compared with anything else for me."

CONSTRUCTION

| | |
|------------------------|---|
| Hull: | Steel, below waterline sandblasted in 2021/22 |
| Superstructure: | Aluminium clad in Teak |
| Deck: | Teak deck new 2012 |
| Windows: | Toughened glass in deckhouse |
| Paint: | Awlgrip Insignia white, Topside Paint in Antigua New 2014, Rigs painted in 2012 |

RIG

| | |
|-------------------------|--|
| Sailplan | Staysail Schooner, set up to be handled by a small deck crew |
| Standing Rigging | Navtec Standing rigging, new in 2012 (Pendennis) |
| Running Rigging | Complete new 2021 |
| Masts | Two, aluminium, with In-Mast furling system by Reckmann, Sanded and repainted in 2012 (Pendennis), Main mast height: 36m |
| Booms | Three, aluminium, sanded and repainted in 2012 (Pendennis) |
| Furlers | Yankee I, Yankee II, Fore staysail, Fisherman, Main staysail and Mainsail are hydraulically furled with Reckmann furlers. |

SAILS/AWNINGS

| | |
|------------------|---|
| Brand | North Sails (New 2023) |
| Foresails | Yankee I, Yankee II, Fore staysail, Fisherman (in mast) |
| Mainsail | One Mainsail (in mast) and Main staysail |
| Sail area | 717 m2 |
| Spinnaker | Asymmetrical, Doyle kite 'Blue' |
| Winches | 8 x Lewmar Ocean 77 2 speed electric 4 x Ocean 68, 3 speed manual 4 x Lewmar wave grip 6, 2 speed manual 5 x Lewmar wave grip 46, 2 speed manual |

DECK EQUIPMENT

| | |
|-------------------------|---|
| Description: | <p>Gloria has a gently sweeping sheerline, with a spoon bow and long overhanging stern. She is a “full keel” yacht with the rudder on the tailing edge. The hull is rendered in steel, and all superstructures are mahogany clad aluminum. All weather decks are sheathed in 5/8” seasoned teak.</p> <p>The bowsprit carries two hydraulic Reckmann furlers for the Yankee #1 and Yankee #2. There are proper handholds on the sprit and netting between the whisker stays. The staysail tack is on the stem, and it is also furled by a Reckmann unit. This staysail is sheeted to a boom whose gooseneck is on a stand just forward of the twin gypsy windlass.</p> <p>The windlass handles the Danforth anchors which are held on stainless steel plates on either side of the bow, and a sail locker accommodates the ropes and fenders. Aft of the windlass a doghouse, flanked by highly polished Dorade vents, provides access to the crew quarters. Four Lewmar winches flank the base of the foremast. Aft of this, the middle deck features the skylights above the main and dining saloons. The yacht’s tenders are carried either side of these skylights. They are recovered and launched by traditional half bow davits with falls. Aft of the main mast, the deckhouse structure is continued aft into the cockpit surround. This cockpit has seating around an expandable mahogany table and, with the addition of two director’s chairs, comfortable dining alfresco for eight.</p> <p>Aft of this the helm with binnacle is the proper John Hastie ship’s wheel and all hydraulic controls. A stainless steel boom crutch with helm seat divides the helmsman from the winch pit. Surrounded by eight self-tailing Lewmar winches, most sailing functions are handled here.</p> <p>Aft of the mainsheet traveler, on the fantail of the yacht, four sunbathing pads provide a very inviting spot to relax. Beneath this area is a large lazarette able to swallow all fenders, lines, and gear.</p> |
| Boarding gangway | 1x Carbon Fibre ‘Painted AWL Grip insignia white’ |
| Bathing ladder | 1x with Teak platform + Boarding stairs on STB side. |
| Deck shower | Yes |
| Anchors | <p>2x Chain, Port 120m, STB 140m</p> <p>Chain in 16mm with Chain wash</p> <p>Chain does not need to be flaked in Locker</p> |
| Windlass | <p>Lofran Super Ercole B for two Chains, electric</p> <p>(completely overhauled by manufacturer in 2002)</p> <p>Serviced annually</p> |
| Capstans | Yes |
| Deck wash system | Yes |
| Awnings | <p>Two big sun awnings covering 2/3 of deck space</p> <p>One Bimini top (new in 2022)</p> |
| Covers | <p>1 x Dinghy</p> <p>1 x Crew entrance</p> <p>2 x Skylights</p> <p>6 x Winchboxes</p> <p>26 x Winches</p> <p>2 x liferafts</p> <p>1 x Gangway</p> <p>1 x steering wheel</p> <p>20 x Fender</p> |

MACHINERY/PROPULSION

| | |
|--------------------|---|
| Main Engine | 1 Caterpillar 3406DT no:4TB00361, 425 HP (322 KW) (completely overhauled by manufacturer in 2002) Serviced every 100hrs (last service May 25) |
| Generator 1 | Stb: Kohler 35KW 50HZ (New 2019), 2'361 hours (05/25) |
| Generator 2 | Port: Kohler 35KW 50HZ (New 2019) 2'284 hours (05/25) |
| Gearbox | Finnoy |
| Propeller | Hundested Feathering Prop |

AUXILIARY EQUIPMENT

| | |
|---------------------------|---|
| Water maker | MT Freshwater 6000 – Rack mounted. Serviced 2025 |
| Bow thruster | PTOMannesmann Rexroth, AA4V40, Thruster ocean yacht system H0400T 63KW (2014) |
| Air conditioning | 2X Climmas CWS 50.000 BTU Chiller units (New 2024), 1 x Dometic Smartstart 220V 50HZ, 30'000 BTU Chiller unit, 1 x Dometic 220 v 50HZ 18'000 BTU (New 2015) . Main Airco with reverse cycle and three Compressors for whole yacht incl. self-contained unit in the Master. |
| Steering gear | Primary 'Hydro control HC', Secondary 'Frizlen', Emergency Tiller attachment in Lazarette |
| Ventilation System | Engine Room + Generator room 380v + 220v systems |

TANKAGE

| | |
|-------------------------|-------------------------------------|
| Fuel tank | 10'000 L. (opened/cleaned in 2022) |
| Fresh water tank | 6'000 L. (opened/painted 2025) |
| Grey water tank | 750 L. (opened/painted 2024) |
| Black water tank | 760 L./600 L. (opened/painted 2022) |
| Oil tank | opened/cleaned 2022 |

PERFORMANCE

| | |
|-----------------------|---|
| Max. speed | under power: 10 Knots under sail: 13 Knots |
| Cruising speed | under power: 9 Knots under sail: 9 Knots |

ELECTRIC SYSTEM

| | |
|------------------------|--|
| Voltages | 380V/220V/50Hz |
| Inverter (V/W) | Victron Pheonix 24v 3000AMP |
| Battery banks | Service, 24 x 6v 220 AMP 24volts 1320 AMP/H (New 2025) Engine start, Freedom Marine 2 x 12v 105 AMP/H. (New 2025) |
| Battery charger | 2 x Victron energy Skyla I 24V 100 AMP Mastervolt Chargemaster Plus, 24V 40 AMPS (New 2020) |
| Shore power | Atlas SPA2 Worldwide shorepower conversion system 380V/220V/50Hz |

NAVIGATION EQUIPMENT

| | |
|---------------------------------|--|
| Autopilot | Robertson AP 45, new in 2002 with 2 steering pumps |
| Compass / gyro | B&G new in 2020 plus two fluid compasses, one new in 2002 |
| GPS / plotter | 1 Leica Chart Nav MK 30, 1 Leica Professional Navigator MK12 Timezero Pro Navigation (New software 2024) B&G Zeus 3s Helm Plotter, (New 2024) |
| Radar | Furuno Multi Color High Performance Shipborne Radar with ARPA (FR 2105 and 18" Industrial LCD Monitor (new screen in 2015/16) |
| Weatherfax | Furuno FAX 207 (new in 2002) |
| AIS | Furuno universal FA-150 |
| Chartplotter | B&G Zeus 3s Helm Plotter, (New 2024) |
| Navtex | Furuno NX-300 |
| Barograph | VEB Feingerätebau |
| Log | B&G Hydra (new in 2020) |
| Depth sounder | B&G (new in 2020) |
| Wind speed + direction | B&G (new in 2020) |
| Close-hauled and running | B&G (new in 2020) |
| Rudder indicator | B&G Analogue (New 2025) |
| Horn | Single Compressor, triple horn configuration |

COMMUNICATION

| | |
|----------------------------|--|
| Telephone | Iridium satphone (2013) |
| VHF radio telephone | Simrad RS 35 (New 2015) + 2 Mobile units 6x IC-M85 HF Marine IC – M802 |
| Computer | Lenovo mini computer, i5 Ram 8GO SSD512Go, New 2024 |
| Screens | 18" Industrial LCD Monitor (new screen in 2015/16) |

ENTERTAINMENT

| | |
|-------------------|--|
| TV/Video | Samsung Home cinema w/ flatscreen 48" DVD & Surround Sound system (Owner cabin) Samsung flatscreen 32" TV & LG DVD (Saloon) Samsung 22" TV & DVD (in VIP guest cabins) |
| Radio/HiFi | 3 Units |
| Others | Wireless network Starlink installed 2024 Satellite television via Tracvision G6 with European Freeserve Box's |

ACCOMMODATIONS

GLORIA interior furnishings and joiner work are rendered in the highest quality mahogany, and features intricate moldings, leaded glass doors, handsome cabinetry, and flawless finishes. She has luxurious accommodations for eight guests in four ensuite staterooms.

Saloon

1x deck saloon with dining table

1x lower saloon with dining area

1x entertainment area with couch

1x bar area with couch, TV/DVD and chimney

Description: A few steps down from the cockpit, the comfortable deckhouse is the crossroads of the yacht. A staircase in the aft port corner leads to a small lobby outside the master stateroom, off which is a convenient day head with shower, which also serves as a second bathroom for the master stateroom. Centrally, forward, a staircase leads down to the main saloon and guest accommodations. In the deckhouse a settee to port faces a breakfast table; the captain's navigation center is forward to starboard, aft of which is the main electrical distribution panel. Large windows surround this deckhouse providing panoramic views.

The main saloon comprises three main parts, making an inverted T. Forming the cross beam of the T are sitting conversational areas to port and starboard, while the "leg" is the dining saloon for 8 pers. forward. The area to starboard has a large and comfortable L-shaped settee facing aft to a built-in flat panel television below a leaded glass crystal display cabinet. A charming working fireplace is outboard with a white marble hearth. Also, a Raritan icemaker is situated within one cupboard.

Opposite to port is a very convivial conversational area with a C-shaped settee facing a writing / music desk. There is exceptional headroom, with two vaulted skylights, several portholes, and the clever use of mirrors to enhance the feeling of space. The oval dining table, with inlaid marquetry compass rose and eight dining chairs, is beneath the forward skylight. The galley is outboard through a sliding door to port and is described in greater detail below.

Owner

1x large owner cabin situated aft

1x double berth with two seating areas

1x en-suite bathroom with jacuzzi and shower

Description: The master stateroom is aft of the deckhouse down a short curving staircase. This impressive room occupies the full beam of the yacht. A king-sized double berth is against the aft bulkhead, flanked by symmetrical L-shaped settees. Four portholes are in the hull sides, and there are two overhead hatches (one being an escape hatch). The very generous bathroom is forward to port with whirlpool tub, marble, mahogany and gold accents.

Guests

1x VIP cabin on Port amidships, with double berth and ensuite bathroom (w/ jacuzzi)

1x VIP cabin on Stb amidships, with double berth and ensuite bathroom

1x guest cabin on Stb, adjacent to dining area, with upper and lower berths and ensuite bathroom

Description: Forward and down from the deckhouse, a generous lobby surrounds the base of the main mast. Either side of this are two almost mirror image guest staterooms one with a queen-sized berth the other features twin single berths that can push together to make a king size double berth. These charming rooms are finished in mahogany with off white

panels. There are two portholes and a deck hatch in each stateroom. Both cabins have marble and mahogany ensuite bathrooms.

The twin berth stateroom is to starboard of the dining saloon and has an ensuite head and shower forward in marble and mahogany.

| | |
|---------------------|---|
| Day bathroom | 1x day bathroom with shower |
| Crew | 1x captain cabin forward of the dining saloon with double berth and ensuite head and shower 1x Cabin Fwd with 3 berths 1x cabin Fwd with 2 berths 1x crew bathroom (new in 2002) |
| Galley | On port, adjacent to the dining area, with separate crew dinette |

APPLIANCES

| | |
|------------------------|---|
| Refrigerator | 600 L. |
| Deep freezer | 450 L. (compressor new in 2002) |
| Bottle cooler | 180 L. Liebherr (new in 2002) |
| Microwave | Miele (new in 2012/13) |
| Stove | Sauter Induction Hob (New 2024) Miele Oven (New 2012/13) |
| Washing machine | ASKO (New 2023) |
| Dryer | Miele (new in 2002) |

TENDER & TOYS

| | |
|--------------------|---|
| Tender | Williams 435 Jet Tender (New 2020), BRP Rotax 1503, 150cc. 230hp 48 hrs (05/25) |
| Crew tender | AB RIB, 4'10 30hp Mercurey outboard New 2022, 40hrs |

SAFETY

| | |
|---------------------------------|--|
| Life raft | Two, Viking SOLAS 10 Persons Rafts |
| Life jackets | 24 |
| Bilge alarm | Two independent Systems 24V + 380V |
| Fire-extinguishing syst. | FM 200, type MA (New 2023), serviced annually. 1x in Saloon bilge, 1x in Lazarette, 1x in engine room |
| Fire-extinguishers | In each cabin, serviced annually |
| EPIRP | Global Fix V4 ACR, New 2020 2x Fixed fire Hoses and Pump |
| Emergency equipment | Johnson 380V Fire pump. |

WORKS & REFIT

2012- Pendennis UK:

- Complete new Teak Deck
- New Navtec standing Rigging carried out by THL in Falmouth
- Access hatches intalled in the Keel for Keel fuel Tank
- New stainless steel exhaust system for the Main engine

2015/16 – Newport, Rhode Island USA:

- New Saloon/cockpit upholstery
- Alpha Laval installed
- New Argonaut display screens 'ships PC and Radar'

2019 – Gosport, UK:

- 2 New Kohler Generators and Dry exhaust system installed
- Kohler 35 KW

2020 – Antibes, France:

- New Jet Tender 'Williams 435' with custom chocks to mount on the Port Deck.
- New B&G H5000 Digital Navigation suite

2021/22 – Antibes, France :

- Complete New Running Rigging
- Sandblast to Bare steel below the Waterline + ultrasonic hull survey by Paul Lockhart

2023 – Antibes, France:

- Complete new suit of North Sails, slight increase of overall sail area achieved.

2024 – Antibes, France:

- New Nav PC with Timezero Navigation
- New Rondal Forestaysail Foil
- New Rondal Fisherman
- 2 New AC Chiller units installed by Penguin Marine.

2025 – Antibes, France:

- Complete new House Bank Batteries + engine start Batteries
- 2 x New Victron Battery chargers
- Maine engine works By Caterpillar: New injectors, New oil cooler, New starter, New Heat exchanger plus housing.

GLORIA





GLORIA



GLORIA



GLORIA



Decksaloon

GLORIA



Nav station



Lower saloon

GLORIA



Lower saloon



Owner cabin



Owner bathroom with jacuzzi



VIP guest cabin

GLORIA



Guest bathroom with jacuzzi

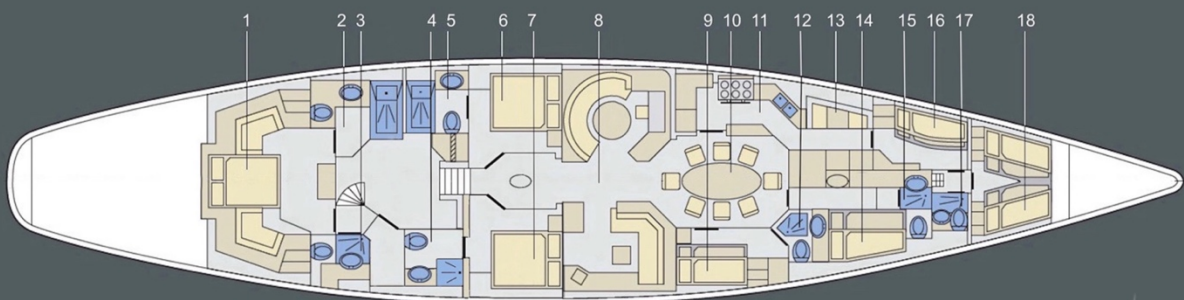

1. Owner cabin
2. Owner bathroom w/ jacuzzi
3. Day head w/ shower
4. Guest head w/ shower
5. Guest head w/ jacuzzi
6. VIP guest cabin
7. VIP guest cabin
8. Saloon
9. Guest cabin

10. Dining area
11. Galley
12. Guest head w/ shower
13. Crew dinette
14. Captain cabin
15. Captain head w/ shower
16. Crew cabin
17. Crew head w/ shower
18. Crew cabin

HAAS
international