

## FOFTEIN STAR



### Main Characteristics

<b>Type</b>	Ketch	<b>Hull material</b>	Aluminium
<b>Shipyard</b>	Royal Huisman, Holland	<b>Length O. A.</b>	25.65 m / 84'15"
<b>Naval Architect</b>	Henry Scheel	<b>Length W. L.</b>	21.71 m / 71'23"
	Royal Huisman Shipyard	<b>Beam</b>	6.35 m / 20'10"
<b>Year</b>	1989 refit 2006 at R.H.S.	<b>Draft</b>	2.4 m / 7'10"
<b>Registry</b>	Valetta, Malta	<b>Gross tonnage</b>	73.84 t / 162,789 lbs
<b>Lying</b>	En-route Azores	<b>Ballast</b>	15.6 t / 34,342 lbs
<b>Price</b>	1'450'000€	<b>Engine</b>	Gardner 6 LXCT Marine 170 HP
<b>VAT Status</b>	Paid	<b>Accommodation</b>	4/5 guests in 2 cabins
			1 captain cabin
			1 crew cabin or guest cabin

### INTRODUCTION

---

Designed by Henry Scheel and meticulously crafted to the highest standards by the renowned Royal Huisman shipyard, the FOFTEIN STAR stands as a timeless and elegant ketch.

Despite her classic appearance, characterized by graceful sheer lines, a fine clipper bow, and a bowsprit, she boasts a plethora of modern technical systems meticulously chosen for their reliability in global cruising.

Owned since launch by an experienced yachtsman deeply passionate about diving and capturing marine life, particularly whales, every facet of her design prioritizes comfort, safety, and seaworthiness.

Featuring a Scheel keel with an exceptionally shallow draft, she facilitates exploration and easy sail handling, thanks to hydraulic furling for all sails and electric winches.

Above deck, the cozy recessed cockpit is well-protected, and there's plenty of deck space, especially for eating under main boom.

The classic and charming interior is a testament to the meticulous attention devoted by Royal Huisman to achieving a traditional ambiance.

Adorned with beautifully paneled cherry wood and granite countertops, it enhances the yacht's simple elegance, warmth, and practicality, embodying the essence of a true Gentleman's yacht.

In 2006 FOFTEIN STAR underwent an extensive refit at Royal Huisman, and her technical and cosmetical condition has remained since then as new.

All systems are fully operational, making her ready for immediate cruising—a delight for any surveyor! She will be sold complete with all equipment on board, including a diving compressor, tanks, and much more.

FOFTEIN STAR stands as a connoisseur's yacht, a timeless masterpiece, and is in exceptional overall condition.

### KEY FEATURES :

- Yacht of best pedigree and of lasting value
- Beautiful classic design and sail plan
- Aluminium hull and mast
- Easy to sail by small crew
- Modern comfort and safety for world-cruising
- Same owner since launch, meticulously maintained
- Exceptional overall condition, ready to sail

**More pictures on request. Virtual tour available.**

## CONSTRUCTION

---

<b>Hull:</b>	Aluminium
<b>Keel:</b>	FOFTEIN STAR has a patented "Scheel Keel" that widens at base in a broadly curved keel bottom. This assures for ballast to be low and creates a strong righting moment whilst reducing wetted surface drag.
<b>Superstructure:</b>	Aluminium
<b>Deck:</b>	Teak
<b>Paint:</b>	Top sides, mast and superstructure in Awlgrip, Antifouling Jotun Megayacht Imperial
<b>Insulation:</b>	Thermic & Phonic: Closed cell foam panels

## RIG

---

<b>Rig:</b>	Rondal, aluminium and stainless rod rigging
<b>Masts:</b>	Main mast 27.00 m above deck, Mizzen 18.50 m above deck
<b>Booms:</b>	Main approx. 9.0 m Mizzen approx. 6.0 m
<b>Spinnaker boom:</b>	7.40 m, aluminium
<b>Reefing system:</b>	Rondal in-mast Hydrofurl for main & mizzen
<b>Standing rigging:</b>	OYS standing rigging new 2007, checked and heads changed in Spring 2015

## SAILS/AWNINGS

---

<b>Sails:</b>	Elvström (Hydra Net), all new 2022
<b>Foresails:</b>	Yankee 141.4 m <sup>2</sup> , staysail 51.9 m <sup>2</sup>
<b>Mainsail:</b>	95.5 m <sup>2</sup>
<b>Mizzen:</b>	43.7 m <sup>2</sup>
<b>Sail area:</b>	332.5 m <sup>2</sup>
<b>Winches:</b>	Lewmar, hydraulic
<b>Awnings:</b>	Fore, mid and aft awnings (mid and aft new 2022, fore unused)

## MACHINERY/PROPULSION

---

<b>Engine:</b>	Gardner 6 LXCT Marine 170 HP (127 kW) complete rebuilt at Factory in 2006 5'162 hours in 09/2023
<b>Fuel consumption Engine:</b>	approx. 16-20 litres/hr
<b>Propeller pitch on engine:</b>	Hundested variable pitch (serviced with new bearings 2022)
<b>Generator:</b>	Northern lights M864W, 20Kw from 2006 4'216 hours in 09/2023
<b>Fuel consumption Generator:</b>	approx. 6 litres/hr
<b>Gearbox:</b>	Twin disk
<b>Prop Shaft:</b>	3 inches (steel)
<b>Propeller:</b>	Three blade Hundested

## PERFORMANCE

---

<b>Max. speed:</b>	<b>under power</b>	Approx. 8.5 knots
	<b>under sail</b>	Approx. 10 knots
<b>Cruising speed:</b>	<b>under power</b>	Approx. 8 knots
	<b>under sail</b>	Approx. 8 knots

## AUXILIARY EQUIPMENT

---

<b>Water maker:</b>	HEM 3 membrane 450 lts p/h (full service and new Membranes 2022)
<b>Power Pack:</b>	Hydraudyne (winches), Rondal (furling)
<b>Bow thruster:</b>	Maxpower R300 (full service and paint 2021)
<b>Air conditioning:</b>	Climma by VECO
<b>Steering gear:</b>	Cable
<b>Ventilation System:</b>	Natural

## TANKAGE

---

<b>Fuel tank:</b>	3'115 ltrs
<b>Fresh water tank:</b>	1'477 ltrs
<b>Wastewater tank:</b>	2 x 200 ltrs

## ELECTRIC SYSTEM

---

<b>Ships electrical power:</b>	24 volts A602/1695 Sonnenschein,
<b>Shore power:</b>	220v 50Hz
<b>Battery Capacity :</b>	13'560 Ah
<b>Voltages:</b>	24 volts / 220volts
<b>Inverter (V/W):</b>	1 x 1'500W at 220volts
<b>Battery banks:</b>	8 x 2-volt 1'695 Ah
<b>Battery charger:</b>	2 x Victron Skylla 24v/100A
<b>Lighting:</b>	24-volt halogen / LED

## COMMUNICATION

---

<b>Telephone:</b>	GSM, Fleetbordband
<b>VHF radio telephone:</b>	Sailor C4900
<b>Satcom:</b>	Fleetbordband, Sat-C Thrane & Thrane
<b>Router:</b>	Pepwave wireless 3G/4G router, new 2015
<b>Computer:</b>	Lenovo (new 2021)
<b>Screens:</b>	EIZO 19"

## ENTERTAINMENT

---

<b>TV/Video:</b>	34" Samsung LCD screen, DVD, VCR
<b>Radio/HiFi:</b>	Bose wireless surround sound system for inside & outside

## NAVIGATION EQUIPMENT

---

<b>Autopilot:</b>	Segatron
<b>Compass / gyro:</b>	Precision 9 (new 2021)
<b>GPS / plotter:</b>	Furuno GP-39 (new 2021), Maxsea Time Zero Pro
<b>Radar:</b>	Furuno DRS4D-NXT 24" (New 2021)
<b>Electronic Charts:</b>	Max Sea Time Zero (new 2021)
<b>Computer:</b>	Lenovo, new 2021
<b>Weatherfax:</b>	Via computer
<b>Navtex:</b>	Via computer
<b>Barograph:</b>	Vetus Meteoline
<b>Log:</b>	B&G
<b>Depth sounder:</b>	B&G
<b>Wind speed + direction:</b>	All sensors are B&G which run through a new A+T processor to new A+T displays.
<b>Close-hauled and running:</b>	B&G
<b>Rudder indicator:</b>	B&G
<b>AIS:</b>	Furuno FA - 150
<b>Searchlight:</b>	Hand
<b>Horn:</b>	Kahlenburg

## ACCOMMODATIONS

---

<b>Owner:</b>	
Cabins:	1 forward master cabin
Berths:	double bed
Bathroom:	1 ensuite
<b>Guests:</b>	
Cabins:	1 guest cabin (port side)
Berths:	2 berth +1 pullman bunk
Bathroom:	1 ensuite
<b>Captain:</b>	
Cabins:	1 captain cabin (port side)
Berths:	1 berth
<b>Crew:</b>	
Cabin:	1 Crew cabin with 2 bunks (stb side) / can be used as guest cabin
<b>Saloon:</b>	1
<b>Galley:</b>	1
<b>Others:</b>	1 dayhead / crew bathroom 1 pilot berth in main salon (stb side)

## APPLIANCES

---

<b>Refrigerator:</b>	Chest style running of 220 V system
<b>Deep freezer:</b>	Chest style running of 220 V system
<b>Stove:</b>	Propane, Alpes Inox
<b>Washing machine:</b>	Miele (new 2023)
<b>Dryer:</b>	Miele (new 2019)
<b>Bottle cooler:</b>	Engle (portable)

## DECK EQUIPMENT

---

<b>Gangway:</b>	Yes
<b>Bathing ladder:</b>	Yes
<b>Deck shower:</b>	Yes
<b>Awning:</b>	Cockpit and maindeck awnings (new 2022 by "Big Boat Covers"), foredeck awning (new 2016 but not used)
<b>Cushions /sun mattresses:</b>	2 x sun beds and 2 x deck lounge / chairs, cockpit cushions.
<b>Covers:</b>	Covers for all varnish and winches
<b>Anchor:</b>	1 x 180 lbs CQR, 1 x 170 lbs Fisherman 1 x 100 lbs Danforth
<b>Windlass:</b>	Steen, electric
<b>Teak deck:</b>	2014: new teak deck on coach roof, main deck re caulked 2019
<b>Paint:</b>	All paint above water line is Awlgrip (off white) Both booms and bulwarks re-painted 2021

## TENDER

---

<b>Tender:</b>	Zodiac Grand Raid MkII
<b>Outboard:</b>	Torqeedo 4Kw electric
<b>Diving gear:</b>	4 new 12ltr dive bottles, 2 BCD's and regulators
<b>Compressor:</b>	Bauer dive compressor

## SAFETY

---

<b>Life raft:</b>	2 x Zodiac 10 persons Solas A (new 2002) both serviced annually, last in 04/2023
<b>Life jackets:</b>	10 x Secumar
<b>Bilge alarm:</b>	Yes
<b>Fire-extinguishing system:</b>	Engine room FH200
<b>Fire-extinguishers:</b>	Portable extinguishers throughout boat
<b>EPIRP:</b>	Mc Murdo
<b>SART:</b>	1
<b>Emergency equipment:</b>	Grab bags, emergency lift strop, rope ladder, fire face shield throw line, rig cutter

## 2006 REFIT AT ROYAL HUISMAN

---

- Complete re-spray of hull, superstructure and masts
- New stainless-steel rod rigging and soft running rigging
- Replacement of all deck fittings with new stainless-steel Rondal deckware
- Reduction in size of engine room to allow for complete redesign of forward area & Guest cabins
- New Master cabin with sofa / office and on-suite bathroom
- New Guest cabin & en-suite bathroom
- New addition of Captain's cabin
- New insulated floor boards throughout
- Complete re-varnish of interior & exterior woodwork

### Engineering:

- Complete rebuild of Gardner Engine
- New Northern Lights 20Kw generator
- New airconditioning system
- Bow thruster installed
- Completely new installation of all service pumps
- Rewiring and ducting of engine room
- New 24v Mastervolt service battery bank

### Navigation Area:

- New navigation equipment
- New Radar
- Flat screen displays
- New communications system
- New B&G instruments

## LAST MAJOR WORKS

---

### Works 2018/2019:

- Complete overhaul and upgrade of the fridge and freezer system with new insulation, more space and new custom build cold plates for @ 30.000€
- Installation of new Beckhoff PLC monitoring system with touch screens that are accessible also remotely via internet connection by Royal Huisman. Costs @ 45.000€

### Works 2019:

- Re-cut and re-seamed all main deck caulking
- Installation of new A+T processor and cockpit displays

### Works 2020:

- Winch powerpack complete service

### Works 2021:

- Installation of new Computers, Radar, Compass and GPS
- Lazarette and Forepeak painted

**Works 2022:**

- Underwater hull sweep sandblasted, faired and new Jotun Megayacht Imperial antifoul applied
- Main and mizzen booms removed and re-painted
- Inner bulwarks re-painted
- Bow thruster removed stripped and rebuilt by AT hydraulics
- Both boom vang serviced
- Hundedst control box removed and serviced with new bearings and new lip seal type (Tides Marine)
- Shaft seal installed.

---

Haas International offers the details of this vessel in good faith but cannot guarantee or warrant the accuracy of this information nor warrant the condition of the vessel. A buyer should instruct his agents, or his surveyors, to investigate such details as the buyer desires validated. This vessel is offered subject to prior sale, price change, or withdrawal without notice.



## Royal Huisman FOFTEIN STAR









## Royal Huisman FOFTEIN STAR



Cockpit



Nav station





Saloon



Galley





Owner cabin



Double/triple guest cabin

## Royal Huisman FOFTEIN STAR



Engine room

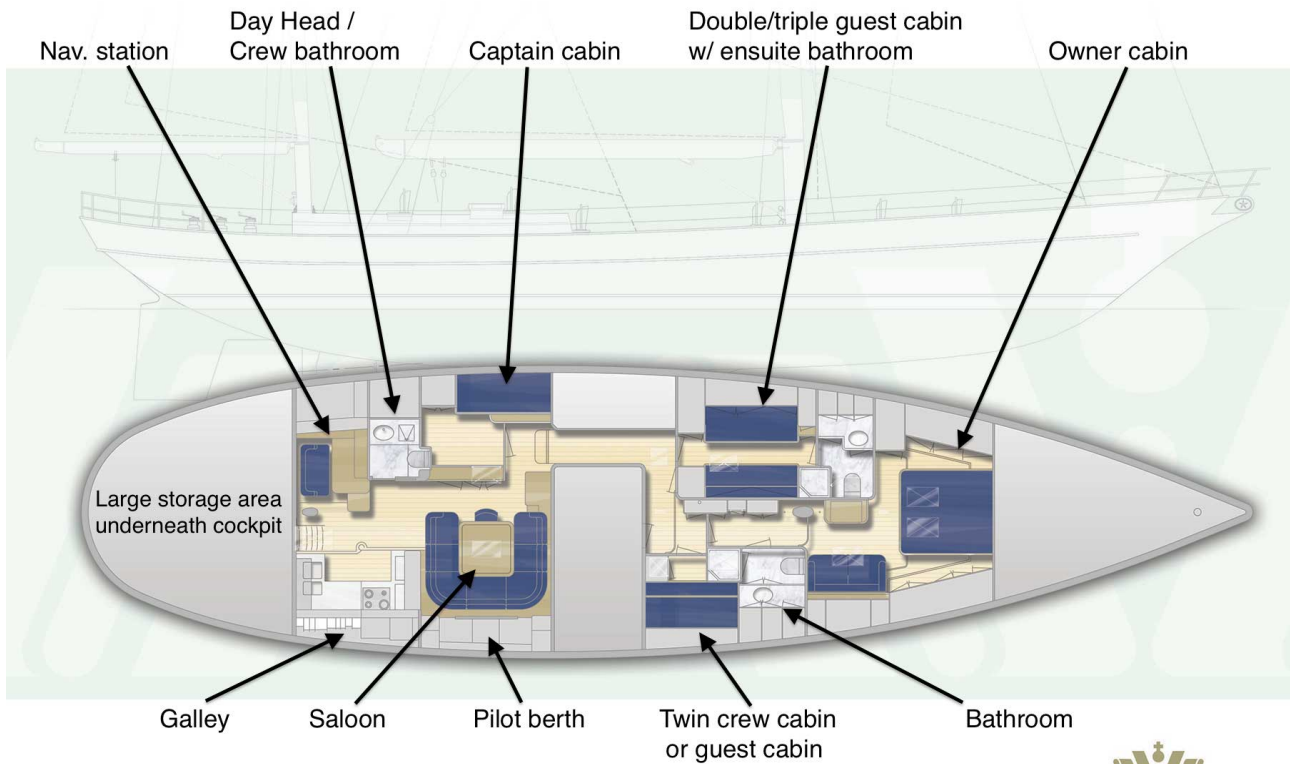

Interior plan SY Foftein